



# 405-420W

G7P54MW | 108-cell

Monofacial Module with White Backsheet  
9BB/10BB/11BB Half-cut Mono Perc



**15** years  
Product  
Warranty

**25** years  
Power  
Warranty

## KEY FEATURES



### 9BB/10BB/11BB Cell

More uniform current collection capability, reducing the current heat loss of the internal cells.



### Lower LCOE

2% more power generation, lower LCOE



### IP68 Junction Box

High waterproof level



### Significantly Lower the Risk of Hot Spot

Special circuit design with much lower hot spot temperature



### Excellent Anti-PID Performance

2 times of industry standard Anti-PID test



## INTRODUCTION

### SYSTEM & PRODUCT CERTIFICATES

- Manufacturer of crystalline silicon photovoltaic modules
- Fully automatic facility and world-class technology
- IEC61215: 2021; IEC61730: 2016; TUV Rheinland Standard
- Lloyd'S Ariel Re Solar Performance Insurance
- ISO 9001 : 2015 Quality Management System
- ISO14001: Environmental Management System
- CE: Europe Standard
- Inmetro Certificate
- Japan JP-AC

### PERFORMANCE WARRANTY

**15** Years Product Warranty    **25** Years Linear Power Warranty

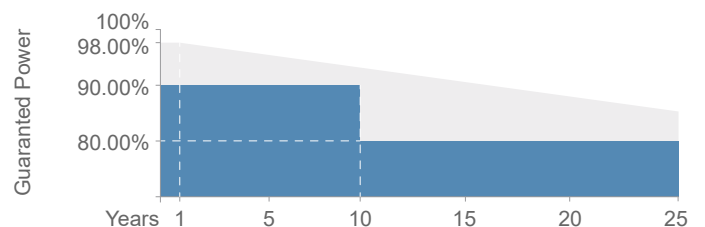

# Andes-G7P54MW 405-420W

**420W**

Output

**21.51%**

Efficiency

**≤2%**

First Year Degradation

**≤0.55%**

Year 2-25 Power Degradation

## Mechanical Characteristics

Weight	20.5kg
Dimension	1722×1134×30mm
Cell Dimension	182×91mm
Cell Amount	54×2 pcs
Maximum System Voltage	1500V
Junction Box	IP68
Frame	Aluminum Alloy
Cable	4.0mm <sup>2</sup> , +300,-300mm/±1100mm Length can be customized
Connector	MC4 compatible
Application Level	Class A

## TECHNICAL DRAWING

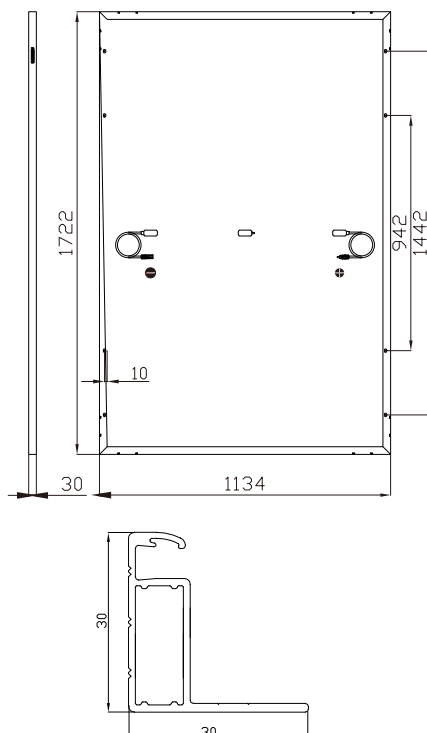

## Packing Configuration

Modules/Pallet	36 Pieces
Packaging Description	26 Pallets, Total=(36+36)×13=936 Pieces
Modules/40' Container	936 Pieces

## Electrical Characteristics (STC: AM1.5 1000W/m<sup>2</sup> 25°C NOCT: AM1.5 800W/m<sup>2</sup> 20°C 1m/s)

Model	G7P54MW-405W		G7P54MW-410W		G7P54MW-415W		G7P54MW-420W	
	STC	NOCT	STC	NOCT	STC	NOCT	STC	NOCT
Testing Condition	STC	NOCT	STC	NOCT	STC	NOCT	STC	NOCT
Maximum Power (Pmax/W)	405	306	410	310	415	314	420	318
Operating Voltage (Vmpp/V)	31.02	29.29	31.22	29.49	31.42	29.71	31.62	29.93
Operating Current (Impp/A)	13.06	10.45	13.14	10.51	13.21	10.57	13.28	10.62
Open-circuit Voltage (Voc/V)	37.14	35.15	37.34	35.39	37.54	35.65	37.74	35.92
Short-circuit Voltage (Isc/A)	13.65	10.92	13.70	10.96	13.77	11.02	13.86	11.09
Modules Efficiency (%)	20.74		21.00		21.25		21.51	

## Temperature Characteristics

NMOT	45±2°C
Temp Coefficient of ISC	+ 0.05%/°C
Temp Coefficient of VOC	- 0.28%/°C
Temp Coefficient of PMAX	- 0.34%/°C

## Maximum Rating

Power selection	0~+5W
Measuring uncertainty of Pm	0~±3%
Operating Temperature	-40°C~+85°C
Wind Load/Snow Load	2400pa/5400pa
Fuse Current	25A

## I-V Characteristics

